

# User manual

## Wet Marking Cart Typ 712/R

Art.Nr. 1115710

### Attention!

Damages which occur as a result of disregard for these operating instructions are not covered by the product guarantee!

Liability for any and all consequential damage is excluded!

Nor do we assume liability for damages to property or personal injury caused by improper use or the failure to observe safety instructions!

The warranty is voided in these cases!

### Safety Instructions for Wet Marking Cart, Typ 712/R

- This product was developed for carpet marking with environmental harmless marking color (no calcium carbonate and colors with thinner).  
Recommendation to use only special carpet colors!
- The unauthorized conversion or/and modification of the product is inadmissible of safety and approval reasons.
- Only trained/experienced operator usage allowed!  
The product should be kept out of the reach of children under 18 years of life!
- The operator has to take care about the working Marking Cart.  
He is responsible to keep the security distance to persons and objects while marking.
- Follow the guidelines of the relevant Accident Prevention & Insurance Associations
- Keep the operation guideline and safety instructions at the Marking Cart.
- Do not carelessly leave the packaging material lying around as this may become a dangerous toy for children.
- Do an inspection of the Pressure Safety relieve valve before operation
- Do not abuse this device for other needs!



Stand 10/2015

# TYPE 712/R

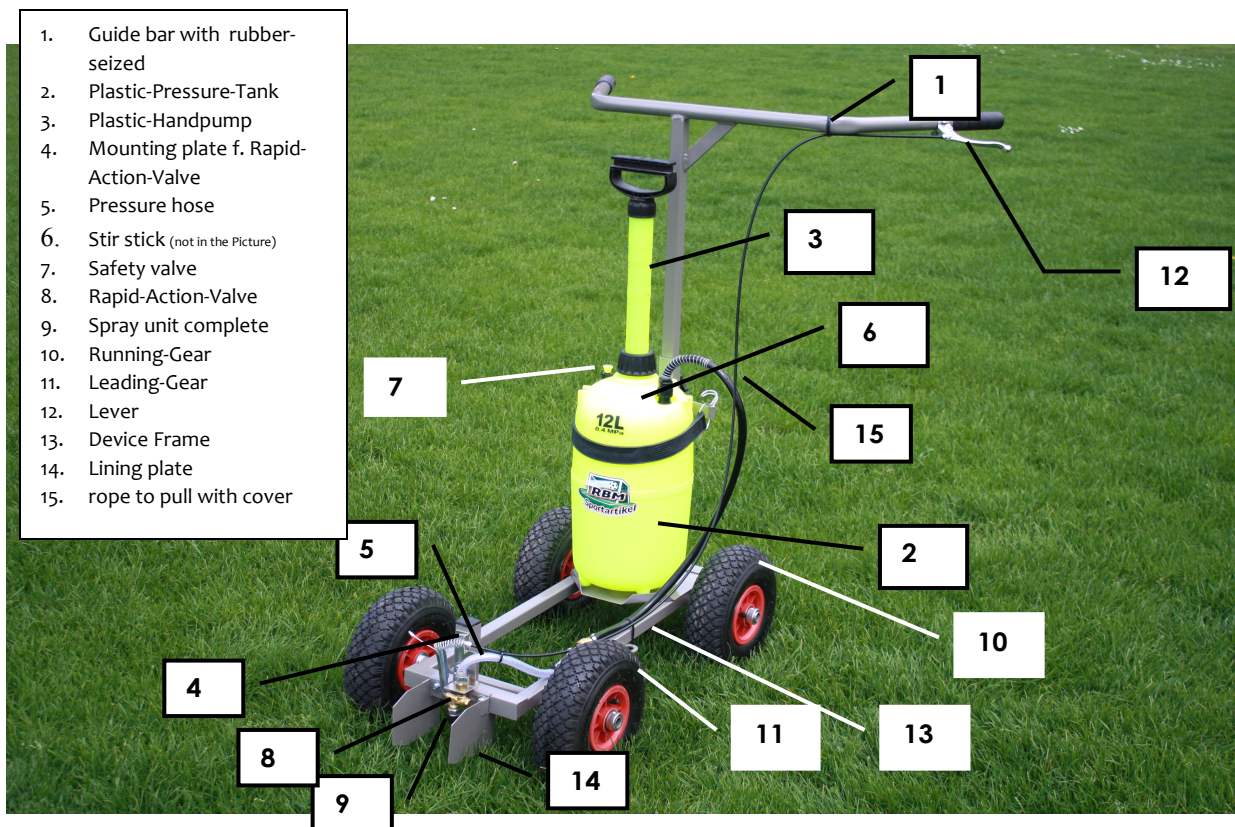

## Operating and servicing wet marking carts

1. When unpacking, ensure that all parts are removed from the cardboard box.
2. Attach the guide bar to the device frame and screw together.
3. Place the plastic pressure tanks on the intended stabling sheet and connect the pressure tubes. The device is now operational.
4. Unscrew hand pump and fill with the finished mixed paint using a funnel, as required (max. 11 litres) and mix with stirrer.
5. Using the hand pump, inflate tanks up to approx. 4,0 bar and check the safety valve function to prevent over-pressure!
6. The marking cart is now ready for marking. With lawns that are to be mowed at either short or long lengths, please ensure the paint nozzle and/or the rapid-action valve is adjusted to the appropriate height.
7. After marking, fill the empty containers with some water, re-pressurize and flush the pressure tube with the rapid-action valve and nozzle. Afterwards, unscrew the paint nozzle and the safety valve and leave it in a small container of water until it is to re-used; this prevents clogging of the small nozzle bore.
8. The marking paints are supplied in 15 kg containers. Please observe the mixing ratio indicated on the paint bucket.

**Please note**, because the pumping unity is beyond the plastic pressure tank, the marking colour can be also kept for a shorter period in the tank, please close the tank well! Please clean after each Marking-procedure the Spray-Unit and the pressure hose under flowing water und attach this again!  
If no more colour is in the tank, clean please everything well!

**In frost keep please no colour in the tank, this can lead to malfunctions!**

# Exploded View

R16	Kunststoff-Behälter
R05	Kunststoff-Handpumpe, komplett
R22	O-Ring, Ø 28x4 mm
R15	Pumpenmutter
R14	O-Ring, Ø 38x5 mm
R24	Ventilteller der Pumpe (Gummi)
M08	Rührhaken (nicht im Bild)
R03d	Sicherheitsventil
R17	Stutzendichtung 22x16x2
R82c	Stutzen
R81e	Schlauchtülle
R80e	Schlauchmutter
R47	O-Ring Ø103 x 2,4 mm
R113	Mutter

### Safety Valve R03d

After the initial inflation of the container (about 5-10 movement of the pump) pull the valve handle - the valve lets the air out. After releasing the handle, the valve should not drain air. Check that the nut of the safety valve R26 is firmly screwed.

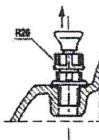

Hinweis:

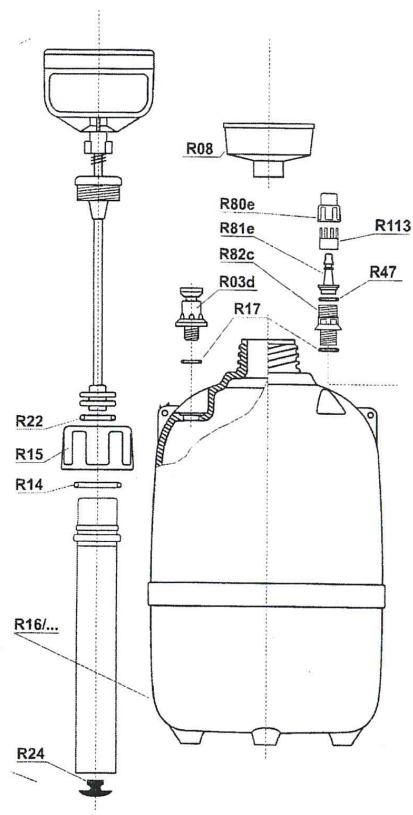

### Maintenance of sprayers:

- Check if the pump works easily. In resistance, remove the pump, unscrew the pump piston, the seals and the cylinder grease with silicone grease. Check whether the safety valve is working. In resistance, the mother of the safety valve, unscrew, remove the valve core, clean, lightly greased with silicone grease. Composed cons, screw the valve nut

### Troubleshooting:

Spray unevenly: nozzle end dirty → Clean

Air is in the hose  
or spraying is interrupted: Intake manifold to tank is not seated firmly in the hose

Pressure is missing: Pump plate is dirty → Clean  
Sealing of the pump piston is worn → Replace  
Silicone grease in the pump is missing → Grease