

Sport-Thieme® Wooden Plyo Box

Thank you very much for choosing a Sport-Thieme product!

Please read the instructions fully before you assemble the equipment, so you can enjoy the product and safety is guaranteed. We are happy to answer any questions you may have.



Assembly instructions for Art.-Nr. 2337904/17

Unpack the 3 in One Plyo Box and make sure you have received all parts before beginning assembly.

PARTS LIST:

- 2 Side Panels marked „A“
- 2 Side Panels marked „B“
- 2 Panels marked „C“ (Top and Bottom Panels)
- 1 Hardware pack
- 3 Internal Support Braces:

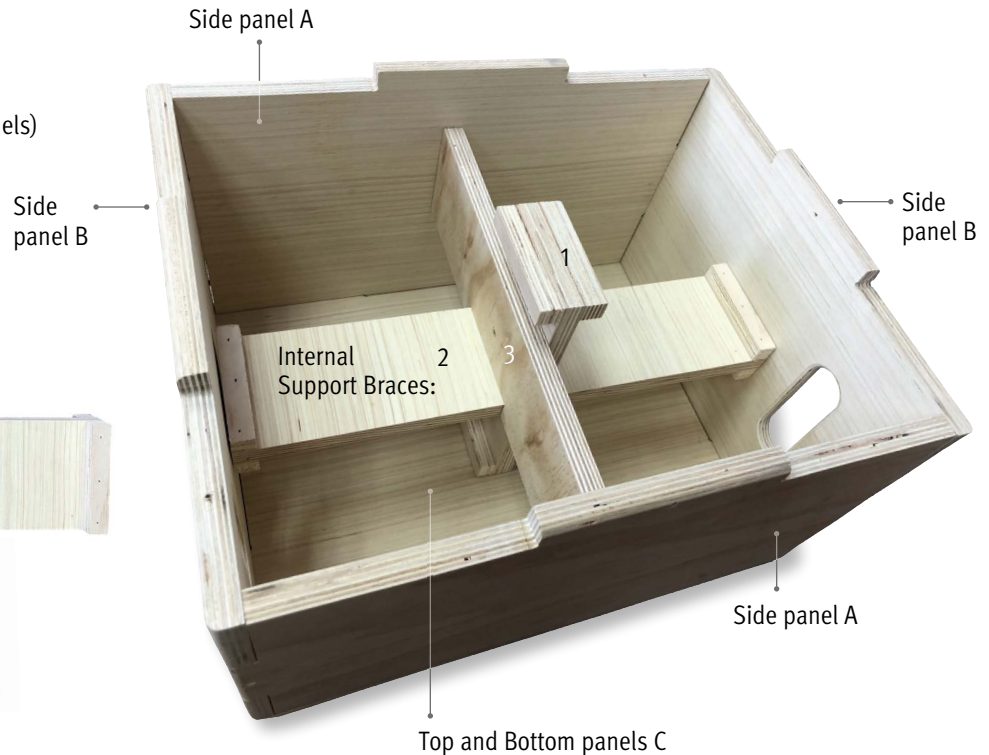
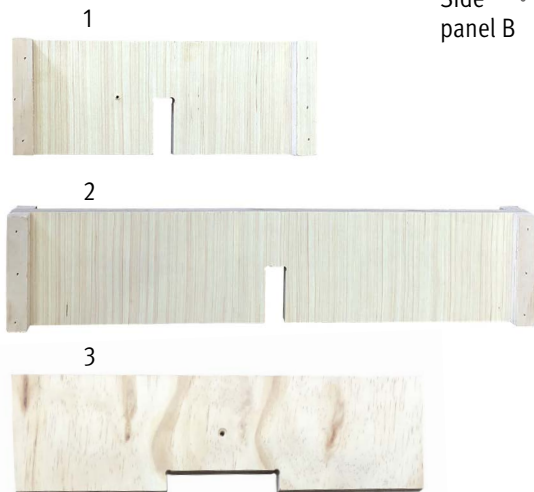

Make sure the arrow marking are on the outside of the Plyo Box.
Wood glue is highly recommended to use for assembly.

Step 1

Assemble on panel „A“ and one panel „B“. Be sure that the top edge of the two panels are lined up and straight. Secure it using 3 screws into the pre-drilled pilot holes. Hand tight the screws about half way. Do not tighten the screws completely. This will allow some play in the final assembly for alignment.

Step 2

Once it's assembled, set it aside then assemble the other Panel A & B. Repeat Step 1.

Step 3

Assemble both halves together and onto the Panel „C“ (Bottom), using screws. Hand tight all screws.

Step 4

Assemble the internal Support Brace – see below. Tighten it using 1 Screw.

Internal Support Braces:

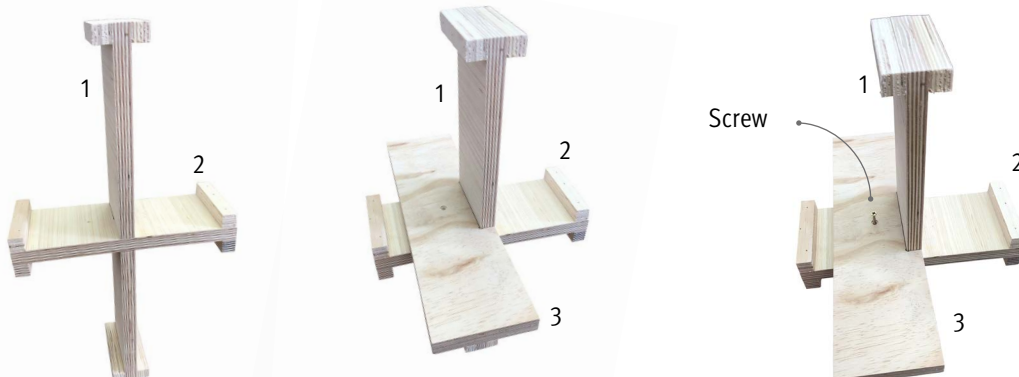

Step 5

Assemble the Top Panel (Panel „C“) using screws. Make sure all panels are straight and aligned. Hand tighten all screws.